



# Electrical Solutions

Complete suspension systems for a variety of  
electrical services



- Aesthetically pleasing
- Easy and efficient installation
- Complete off-site solutions



## Trapeze Plus FR 🔥

Page 4

## Trapeze Plus Cable Basket Adaptor

Page 5

## Fast Trak - Segregated 🔥

Page 9

## Universal Bracket 🔥

Page 10

## Fire Rated Clip 🔥

Page 11

## Standard Hanger

Page 12

## Fast Trak - Standard 🔥

Page 6

## Fast Trak - Low Profile 🔥

Page 7

## Express

Page 13

## UniGrip

Page 14

## Fast Trak - Side Loading 🔥

Page 8

## Catenary & C-Clip

Page 15

## Y-Fit & Y-Fit Accessory

Page 16

**The Gripple®** range of supports and hangers for electrical applications has been developed to provide a fast and versatile solution for suspending all types of electrical containment.

**Gripple products** are designed to save time, labour and reduce costs by making the installation quicker and easier. Supplied in ready-to-use kits, the products in this range are lightweight, require no on-site cutting and reduce the time spent at height, offering enormous health and safety benefits for your project.



# Trapeze Plus FR

Designed for quick attachment to both channel and Gripple brackets for the fast suspension of a variety of applications including HVAC, pipework and electrical containment where fire resistance is required.

**Fire rated** – tested to F120 to the temperatures associated with BS476 Part 20 / DIN4102 Part 2. For certification to support load limits and exposure times, contact Gripple Technical Services

**Simple** – fast and easy installation using the washer or channel nut supplied to pre-install into Gripple Universal Bracket or channel reducing time spent working at height

**Quick** – integral adjustment button allows for rapid adjustment, no Setting Key required

**Secure** – locking screw prevents movement of services once positioned

**Strong** – industry approved

**Safe** – no tools or 'hot works' permit required for installation, improving health and safety on-site

**Versatile** – available in three sizes with a choice of channel nut or flange nut fixings. Also available as a side exit hanger for applications where wire cannot exit centrally (avoiding clashes with services)

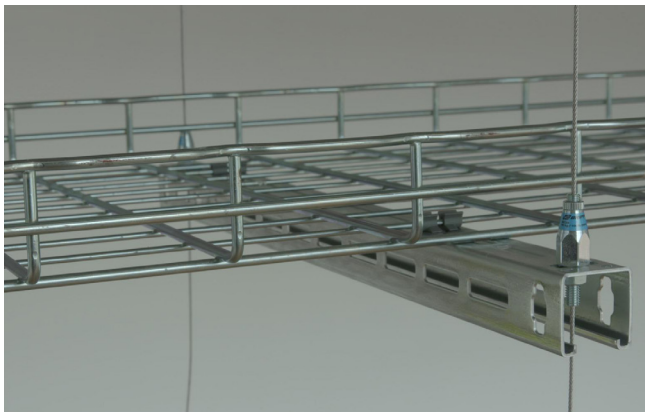
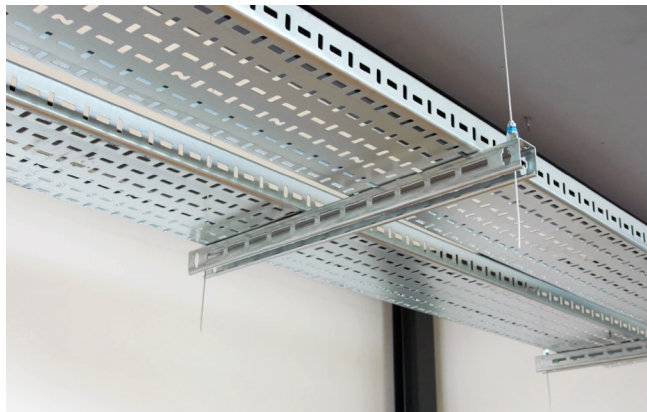

## Available Sizes and Load Ratings

	<b>No. 2</b> 45 kg SWL (3:1)		<b>No. 3</b> 90 kg SWL (3:1)		<b>No. 4</b> 225 kg SWL (3:1)
--	------------------------------------	--	------------------------------------	--	-------------------------------------

All hangers are supplied as ready-to-use kits with a length of wire rope and end fixing of your choice.

## Installation Steps

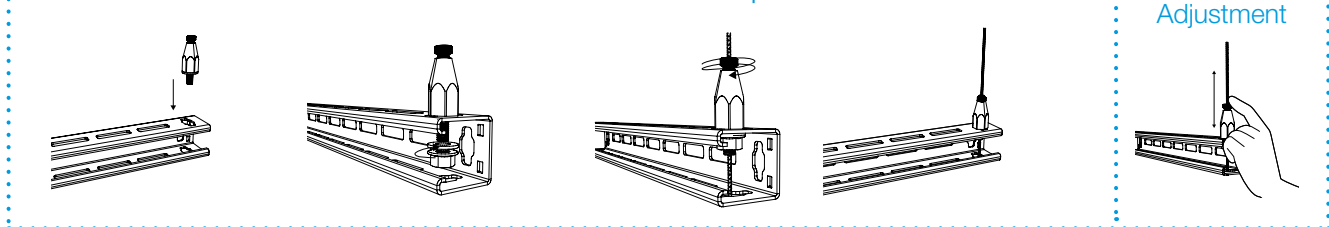

Contact Gripple for full product information, submittal data and technical support.

**End Fixings**  
Page 17

**Product Codes**  
Page 20

+44 (0) 800 018 4264  
[www.gripple.com](http://www.gripple.com)

# Trapeze Plus FR - Cable Basket Adaptor

Designed for quick attachment to cable basket for the fast suspension of electrical containment where fire resistance is required.

**Fire rated** – supplied with stainless steel wire. BRE tested to F120 to the temperatures associated with BS476 Part 20 / DIN4102 Part 2. Independent test data available with load limits and exposure times

**Simple** – fast and easy installation using the washer or channel nut supplied to pre-install into Gripple Universal Bracket or channel reducing time spent working at height

**Quick** – integral adjustment button allows for rapid adjustment, no Setting Key required

**Secure** – locking screw prevents movement of services once positioned

**Strong** – industry approved

**Safe** – no tools or 'hot works' permit required for installation, improving health and safety on-site

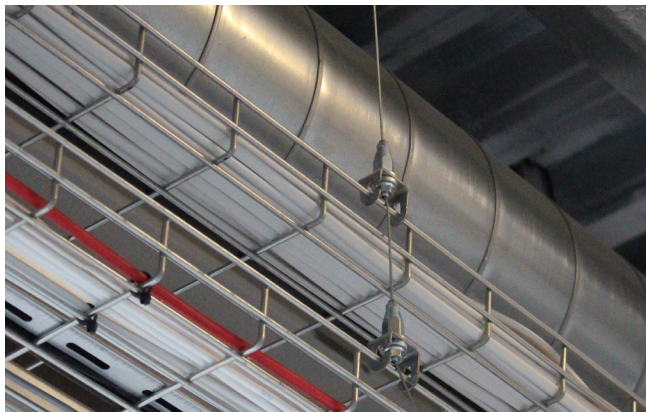

## Available Sizes and Load Ratings

	<b>No. 2</b> 45 kg SWL (3:1)		<b>No. 3</b> 90 kg SWL (3:1)		<b>No. 4</b> 225 kg SWL (3:1)
--	------------------------------------	--	------------------------------------	--	-------------------------------------

All hangers are supplied as ready-to-use kits with a length of wire rope and end fixing of your choice.

## Installation Steps

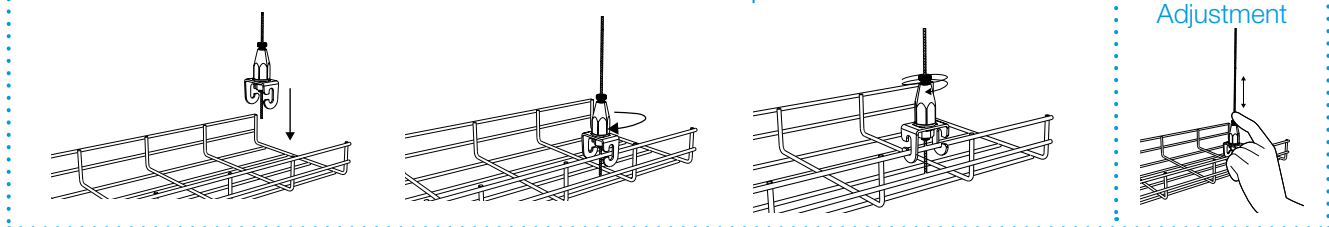

Contact Gripple for full product information, submittal data and technical support.

**End Fixings**  
Page 17

**Product Codes**  
Page 20

+44 (0) 800 018 4264  
[www.gripple.com](http://www.gripple.com)



# Fast Trak® - Standard

Pre-fabricated trapeze bracket solution offering speed, flexibility and efficient use of space, for the installation of electrical containment, pipework, ductwork and other mechanical services in restricted places.

- Fire Rated** – tested to F120 in accordance with BS EN 1363-1:2012 temperature curve\*
- Quick** – up to six times faster to install than traditional suspension systems
- Safe** – pre-fabricated system which removes the need to cut threaded rod or channel on-site
- Tool free adjustment** – bracket can be moved up and down the tracks to accommodate changes in position during installation
- Zero waste** – tracks bend neatly under bracket
- Versatile** – four-sided bracket provides suspension point on every face
- Easy measurement** – indicators for marking fixing points on the ceiling; M4 level markers on the tracks highlight 50 mm increments, no leveling tools required
- Neat & tidy** – system can be ‘stacked’ on-site to reduce storage requirements
- Space saver** – can be multi-tiered to accommodate additional services



## Available Bracket Sizes Available Track Sizes



**System Rating**  
Up to 200 kg<sup>1</sup> SWL (3:1)

**Bracket Sizes**  
170 mm - 1470 mm

Bracket sizes increase in 100 mm increments



**Track Sizes**  
200 mm - 1500 mm

Track sizes increase in 100 mm increments

## Installation Steps

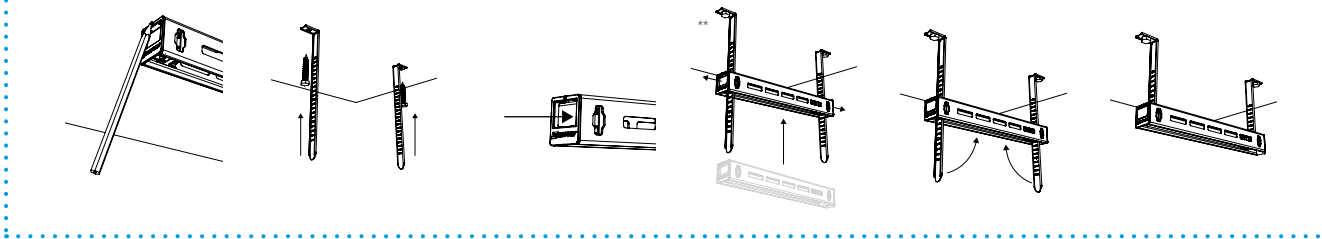

\*Fire Fastener needed when used channel-side up ('u' orientation). \*\*When installed correctly, button must be fully retracted and flush with the cartridge edge. Do not adjust under load. Contact Gripple for full product information, submittal data and technical support. <sup>1</sup>Tested at ambient temperatures, see bracket data on page 12 for maximum working load. Excess tracks can also be snapped off once bracket is levelled & secured for a neater finish. Bending tracks by hand is not recommended when excess is under 100 mm.

# Fast Trak® - Low Profile

A space efficient low profile pre-fabricated trapeze bracket. Ideal for use with electrical containment, pipework and mechanical services in ultra-restricted ceiling spaces.

- Fire Rated** – tested to F120 in accordance with BS EN 1363-1:2012 temperature curve
- Space saver** – 21 mm bracket depth is even lower profile than standard Fast Trak range
- Quick** – up to six times faster to install than traditional suspension systems
- Safe** – pre-fabricated system which removes the need to cut threaded rod or channel on-site
- Tool free** – bracket can be moved up and down the tracks to accommodate changes in position during installation
- Easy measurement** – indicators at each end of the bracket can be used as a measurement guide when marking fix points in the ceiling
- Neat & tidy** – system can be ‘stacked’ on-site to reduce storage requirements
- Aesthetic** – tracks bend neatly under bracket



## Available Bracket Sizes Available Track Sizes



**System Rating**  
Up to 75 kg<sup>1</sup> SWL (3:1)

**Bracket Sizes**  
190 mm - 1490 mm

Bracket sizes increase in 100 mm increments



**Track Sizes**  
200 mm - 1500 mm

Track sizes increase in 100 mm increments

## Installation Steps

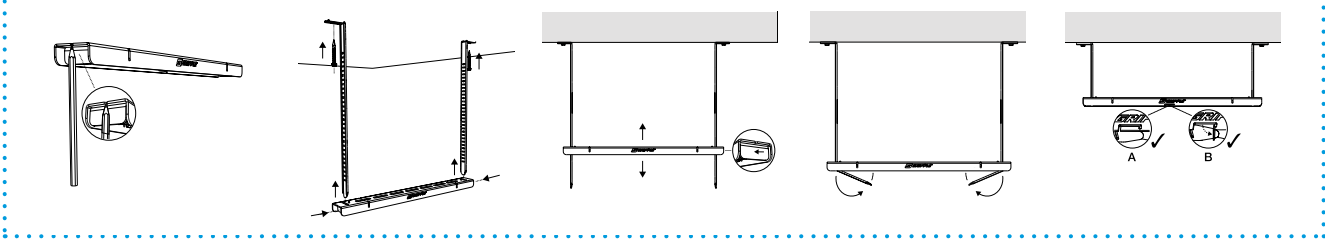

Do not adjust under load. Contact Gripple for full product information, submittal data and technical support. <sup>1</sup>Tested at ambient temperatures, see bracket data on page 12 for maximum working load. Excess tracks can also be snapped off once bracket is levelled & secured for a neater finish. Bending tracks by hand is not recommended when excess is under 100 mm.



# Fast Trak® - Side Loading

Pre-fabricated side loading bracket solution offering speed and flexibility for the installation of lightweight electrical containment, pipework, ductwork and other mechanical services in restricted places.



- Fire Rated** – tested to F120 in accordance with BS EN 1363-1:2012 temperature curve
- Quick** – up to six times faster to install than traditional suspension systems
- Safe** – pre-fabricated system which removes the need to cut threaded rod or channel on-site
- Tool free** – bracket can be moved up and down the tracks to accommodate changes in position during installation
- Secure** – safety locks ensure security once brackets and tracks are in place
- Space saver** – can be multi-tiered to accommodate additional services
- Easy installation** – lightweight services can be side loaded onto the bracket
- Neat & tidy** – system can be ‘stacked’ on-site to reduce storage requirements



Available Bracket Sizes		Available Track Sizes	
Single Load¹ FTBS-180 – 15 kg 3:1 SWL	Twin Load¹ FTBT-200 – 30 kg 3:1 SWL FTBT-300 – 30 kg 3:1 SWL FTBT-400 – 30 kg 3:1 SWL	Track Sizes 200 mm - 600 mm	Track sizes increase in 100 mm increments

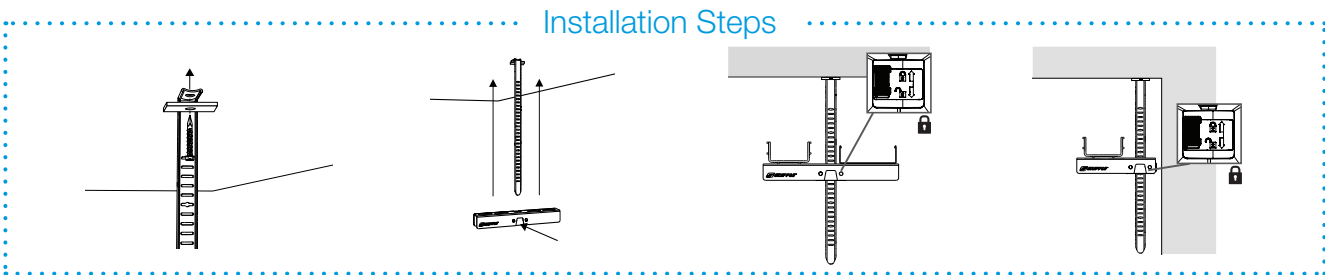

Do not adjust under load. ¹Tested at ambient temperatures, contact Gripple for full product information, submittal data and technical support. Excess tracks can also be snapped off once bracket is levelled & secured for a neater finish. Bending tracks by hand is not recommended when excess is under 100 mm.

# Fast Trak® - Segregated

Pre-fabricated side loading bracket solution offering speed and flexibility for the installation of lightweight services that require separation such as data and power cables.



- Fire Rated** – tested to F120 in accordance with BS EN 1363-1:2012 temperature curve
- Quick** – up to six times faster to install than traditional suspension systems, lightweight services can be side loaded onto the bracket
- Safe** – pre-fabricated system which removes the need to cut threaded rod or channel on-site
- Compliant** – adheres to regulations where electrical and power must be separated by a required distance
- Tool free adjustment** – bracket can be moved up and down the tracks to accommodate changes in position during installation
- Secure** – safety locks ensure security once brackets & tracks are in place
- Space saver** – can be multi-tiered to accommodate additional services
- Easy measurement** – indicators above adjustment buttons on the bracket offer a measurement guide when marking fixing points on the ceiling; M4 level markers on the tracks highlight 50 mm increments, with no leveling tools required
- Neat & tidy** – system can be ‘stacked’ on-site to reduce storage requirements



Available Bracket Sizes		Available Track Sizes	
Bracket¹ FTBSG-130 – 2 x 22.5 kg 3:1 SWL FTBSG-240 – 2 x 22.5 kg 3:1 SWL FTBSG-350 – 2 x 22.5 kg 3:1 SWL	Track Sizes 200 mm - 600 mm	Track sizes increase in 100 mm increments	

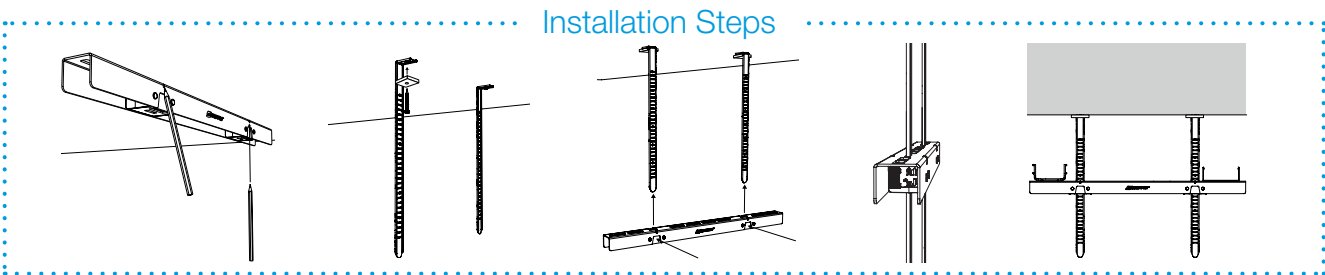

Do not adjust under load. ¹Tested at ambient temperatures, contact Gripple for full product information, submittal data and technical support. Excess tracks can also be snapped off once bracket is levelled & secured for a neater finish. Bending tracks by hand is not recommended when excess is under 100 mm.



# Universal Bracket

Universal Brackets are designed for quick and easy support of electrical containment, pipework and other mechanical services.



**Fire Rated** – tested to F120 in accordance with BS EN 1363-1:2012 temperature curve. See 'u' orientation section on Fire Rated Product Matrix, contact Gripple Technical Services for more information

**Quick** – pre-cut lengths eliminate the need for cutting channel on-site, allowing more productive use of labour

**Versatile** – can be bolted directly to soffit or wall, or suspended from the soffit using a Gripple Hanger e.g. Trapeze Plus FR

**Compatible** – uniform slots on three sides allow accurate alignment of Gripple clamps and QT accessories with the fourth side permitting the use channel / strut accessories

**Safe** – improved health and safety as no tools or 'hot works' permit required for installation

**Strong** – increased load ratings of up to 200 kg, available in sizes ranging from 235 mm to 1535 mm

**Flexible** – perfect for multi-service installations

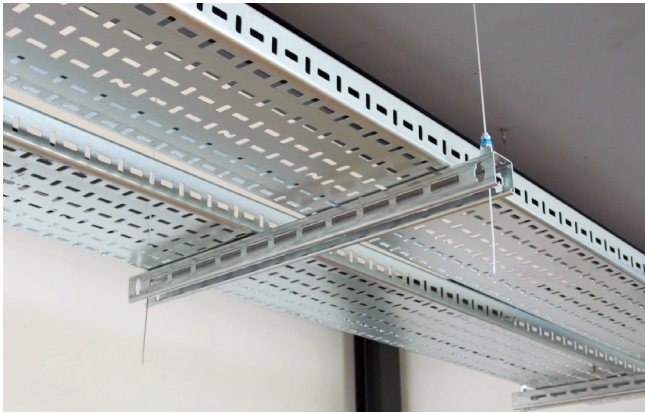
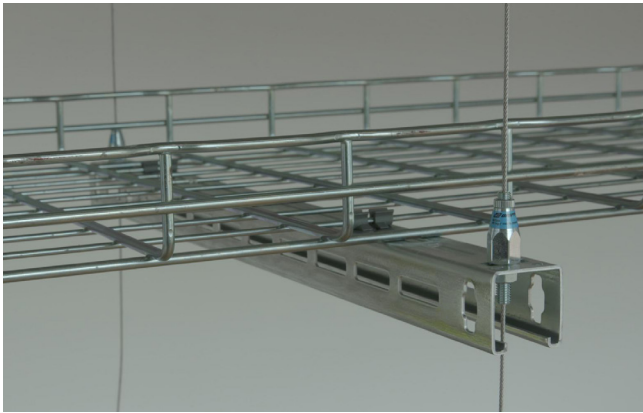

## Size Variants<sup>1</sup>

	<b>System Rating<sup>1</sup></b> Up to 200 kg SWL (for full submittal data please contact Gripple)	<b>Bracket Size</b> Available in 100 mm increments from UB-170 - UB-1470*
--	--	--

## Installation Steps



Do not adjust under load. <sup>1</sup>Tested at ambient temperatures, contact Gripple for full product information, submittal data and technical support.  
\*Product codes relate to suspension space for positioning services onto the brackets, not the full length of the bracket.

End Fixings  
Page 17

Product Codes  
Page 20

+44 (0) 800 018 4264  
[www.gripple.com](http://www.gripple.com)

# Fire Rated Clip

A time and labour saving fire rated cable fastener for direct suspension of cables to ceilings or walls.



**Quick** – direct fixing of cables to ceilings and walls

**Fire resistant** – rated to 30 minutes

**Ready-to-use** – supplied with a fire rated concrete screw

**Versatile** – single sided and double sided clip for various amounts of cable

**Labour saving** – considerably simplified installation when compared to tray and basket

**Secure** – wire is flexible to allow easy installation of cable, and durable to secure once in place

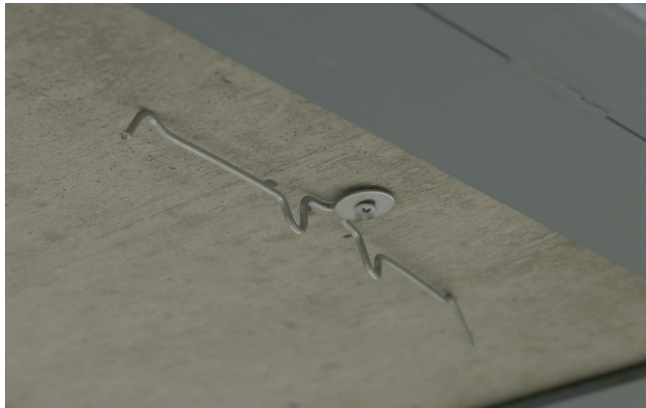
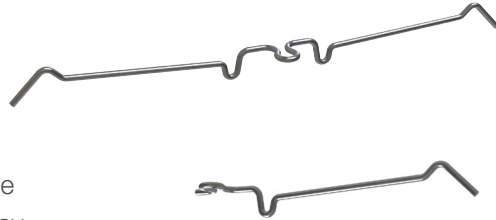

	<b>Single</b> 0.24 kg SWL		<b>Double</b> 2 x 0.24 kg SWL
--	------------------------------	--	----------------------------------

Load ratings given are based on F30 Fire Resistance.

## Installation Steps

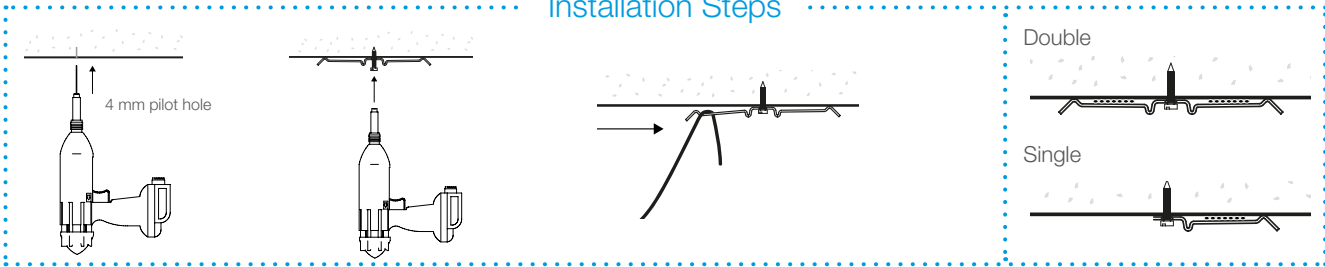

End Fixings  
Page 17

Product Codes  
Page 20

+44 (0) 800 018 4264  
[www.gripple.com](http://www.gripple.com)



# Standard Hanger

A versatile suspension kit for a variety of applications including the suspension of HVAC, pipework and electrical containment from different substrates.

**Quick** – fewer components compared to traditional methods, up to six times faster to install than traditional suspension systems

**Safe** – no tools or 'hot works' permit required for installation, improving health and safety on-site

**Strong** – industry approved, conforms to DW/144

**Lightweight** – easy to move and handle on-site, whilst reducing the load on the building structure

**Aesthetic** – the design complements enclosed and open soffit spaces

🔥 Fire Rated Hanger version available. Contact Gripple Technical Services for more information.



## Available Sizes and Load Ratings

	<b>No. 1</b> 10 kg SWL (5:1)		<b>No. 2</b> 45 kg SWL (5:1)		<b>No. 3</b> 90 kg SWL (5:1)		<b>No. 4</b> 225 kg SWL (5:1)		<b>No. 5</b> 325 kg SWL (5:1)
--	---------------------------------------	--	---------------------------------------	--	---------------------------------------	--	--	--	--

All hangers are supplied as ready-to-use kits with a length of wire rope and end fixing of your choice.

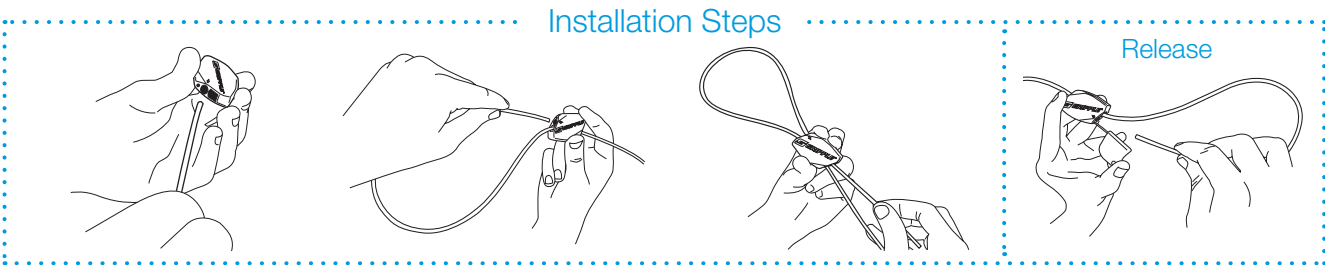

Do not adjust under load. Contact Gripple for full product information, submittal data and technical support.

# Express

Tool free suspension kit designed with a keyless release mechanism for fast suspension of a variety of applications from different substrates including M&E, lighting, signage and acoustics.

**Versatile** – Express No. 1 is ideal for signage, shop fitting, lighting and other lightweight fixtures. Express No. 2 is ideal for mechanical and non fire-rated electrical applications

**Quick** – ergonomic buttons allow for rapid adjustment, no Setting Key required

**Safe** – no tools or 'hot works' permit required for installation, improving health and safety on-site

**Aesthetic** – the design complements enclosed and open soffit spaces

**Lightweight** – easy to move and handle on-site, whilst reducing the load on the building structure

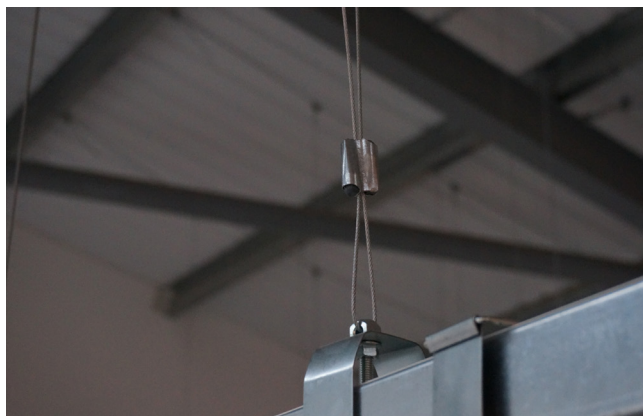

## Available Sizes and Load Ratings

	<b>No. 1</b> 15 kg SWL (5:1)		<b>No. 2</b> 45 kg SWL (5:1)
--	---------------------------------------	--	---------------------------------------

All hangers are supplied as ready-to-use kits with a length of wire rope and end fixing of your choice.

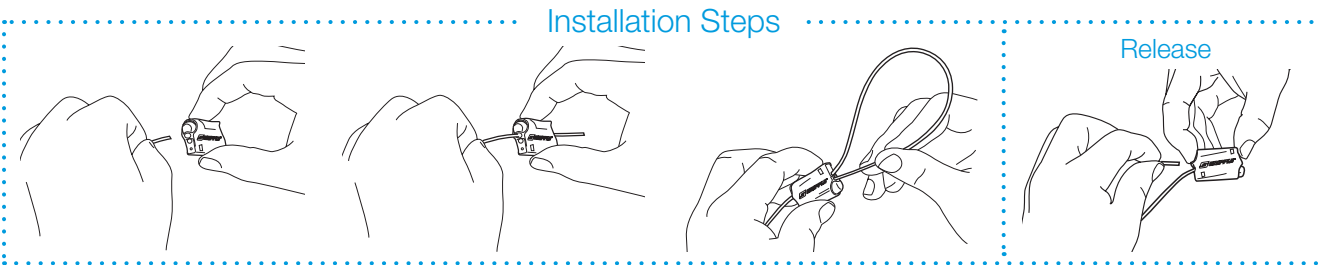

Do not adjust under load. Contact Gripple for full product information, submittal data and technical support.





# UniGrip

The next generation of wire rope suspension products designed for the fast suspension of cable containment, pipework, ductwork, HVAC systems and modules including multi-tier installations.

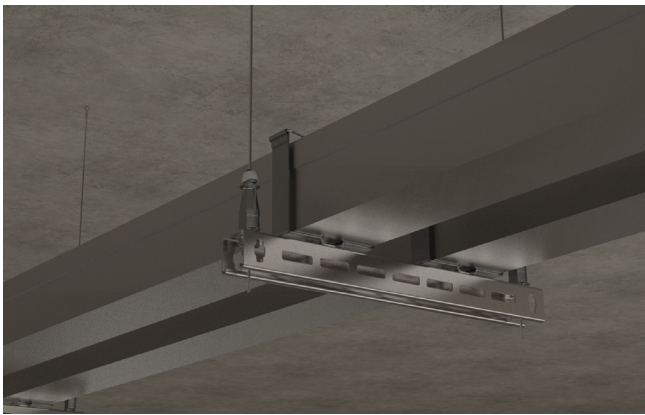
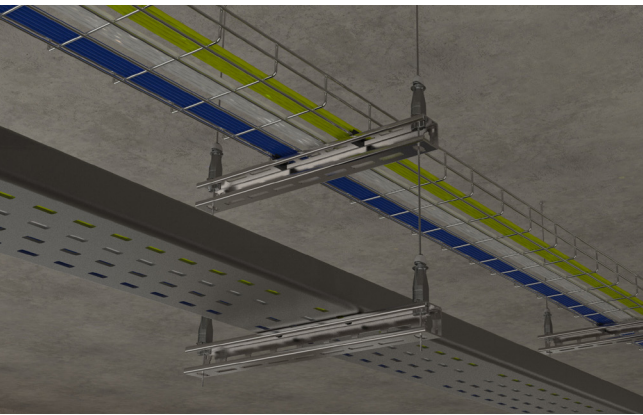
- Quick** – up to 6 times faster than traditional suspension systems
- Safe** – can be pre-installed to channel using pre-fitted washer/nut or using retention clip reducing time working at height
- Easy** – integral ergonomically designed release button allows for simple adjustment
- Secure** – button acts as a locking screw and indicator clearly highlights the wire is locked in position for ultimate security
- Versatile** – variety of foot attachments available to suit applications
- Strong** – highest load rating capability to date, up to 250 kg SWL with a 5:1 safety factor



## Available Sizes and Load Ratings

	<b>No. 2</b> 55 kg SWL (5:1)		<b>No. 3</b> 110 kg SWL (5:1)		<b>No. 4</b> 250 kg SWL (5:1)
---	------------------------------------	---	-------------------------------------	---	-------------------------------------

All hangers are supplied as ready-to-use kits with a length of wire rope and end fixing of your choice.

## Installation Steps

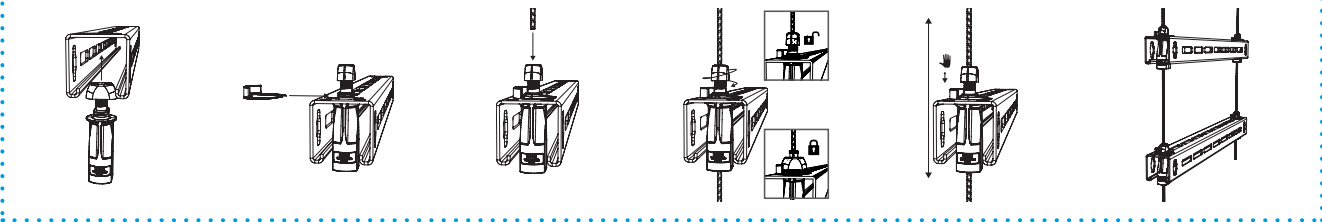

Contact Gripple for full product information, submittal data and technical support.



# Catenary Kit & C-Clip

Create secure, overhead spans by running high strength wire rope between two fixing points. Ideal for applications where no direct vertical anchor point is available.

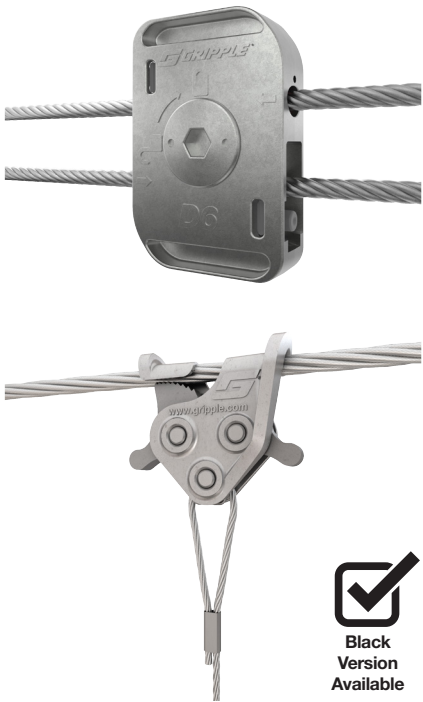
- Versatile** - can easily be used for a variety of applications including lighting, HVAC, pipework and electrical containment
- Quick** - fewer components compared to traditional methods, up to six times faster to install than traditional suspension systems
- Aesthetic** - the design complements enclosed and open soffit spaces providing a discrete finish
- Safe** - no 'hot works' permit required for installation, improving health and safety on-site
- Easily tensioned** - using the Gripple Catenary Tensioning Tool reducing time spent working at height
- Secure** - locking mechanism in the Lockable Plus prevents dynamic movements
- Strong** - industry approved
- Lightweight** - easy to move and handle on-site, whilst reducing the load on the building structure



## Available Sizes and Load Ratings

	<b>No. 3</b> 30 kg SWL (free span) (5:1)		<b>No. 6</b> 100 kg SWL (free span) (5:1)
---	--	---	---

All hangers are supplied as ready-to-use kits with a length of wire rope and end fixing of your choice. For example, 3 mm and 6 mm C-Clip end fixings available. 3 mm version up to 15 kg SWL and 6 mm version up to 55 kg SWL (5:1).

## Installation Steps

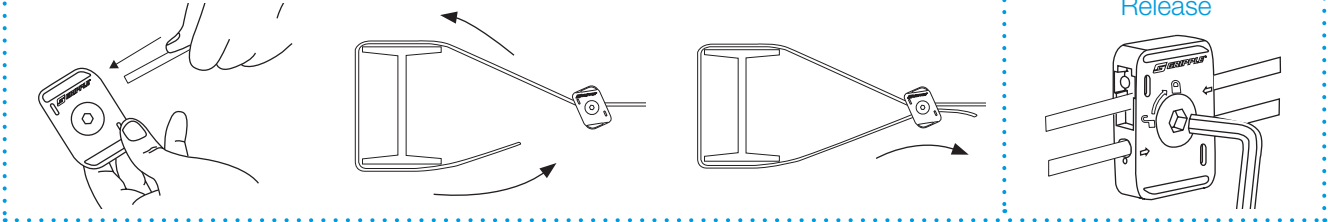

Do not adjust under load. Contact Gripple for full product information, submittal data and technical support.



Y-Fit & Y-Fit Accessory

Ideal for balanced containment, lighting and pipework.

- Simple** – single point suspension with double hanging points to enable one leg to be detached to allow access to cables, etc.
- Versatile** – variety of different end fixings including Snap Hook, Cable Tray Hook, Toggle and Karabiner for attachment to a wide range of services
- Quick & easy installation** – accessory version is ideal for longer drops to easily reach services for adjustment
- Safe** – no tools or 'hot works' permit required for installation, improving health and safety on-site
- Strong** – industry approved
- Fire Rated** – Y-Fit Accessory only. Tested to BS EN 1363-1:2012. For more information please contact Gripple Technical Services

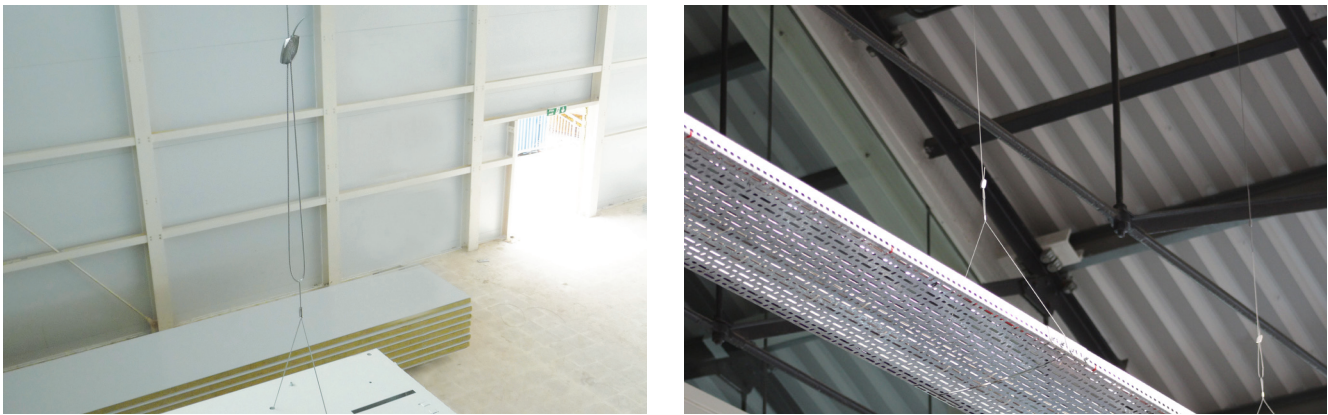
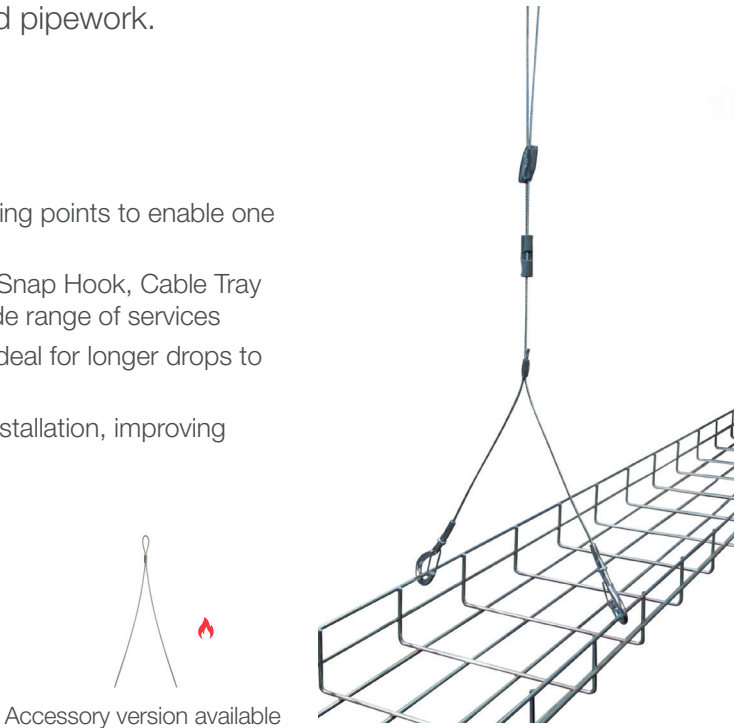

Available Sizes and Load Ratings					
	<b>No. 1</b> 10 kg SWL (5:1)		<b>No. 2</b> 45 kg SWL (5:1)		<b>No. 3</b> 90 kg SWL (5:1)

All hangers are supplied as ready-to-use kits with a length of wire rope and end fixing of your choice.

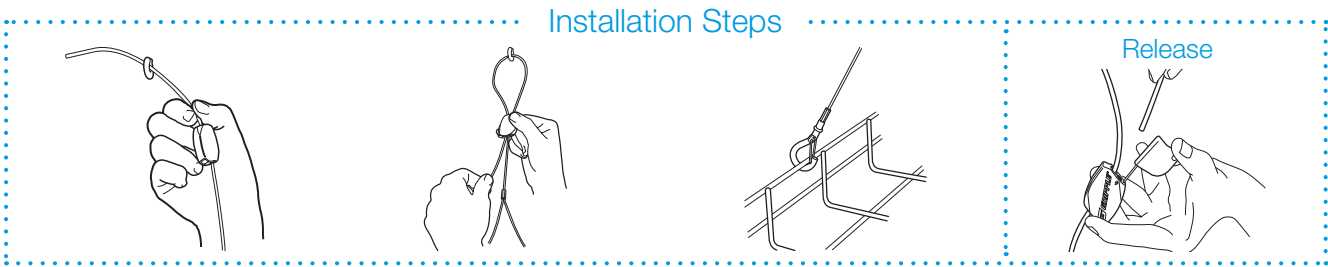

Do not adjust under load. Contact Gripple for full product information, submittal data and technical support.

End Fixings

All Gripple Hanger kits are supplied with a pre-crimped End Fixing and your choice of wire rope length, suitable for installation into any substrate.



Loop

- Ideal for looping around purlins, beams, roof trusses and other suitable building features
- Available up to 325 kg SWL with a 5:1 safety factor
- Available in Stainless Steel

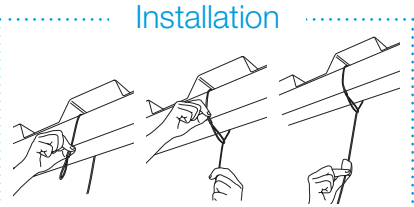

Stud

- Ideal for anchoring into concrete ceilings and Channel Nuts
- Supplied with a Drop-in Anchor
- Available in Gripple sizes No. 2, No. 3 and No. 4 with a 5:1 safety factor
- Available in Stainless Steel

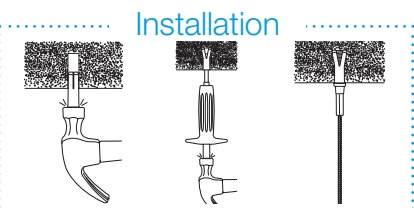

Toggle

- Ideal when used as a Y-Fit to suspend lighting
- Available up to 90 kg SWL with a 5:1 safety factor
- Comes as a complete kit with Gripple wire rope and hanger
- Available in Stainless Steel

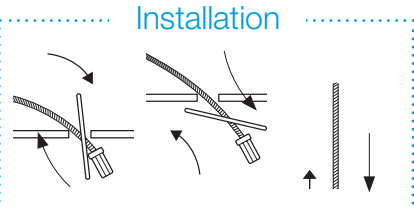

Snap Hook

- Quick and easy attachment to cable basket, purlin clips, light fittings
- Available in Gripple sizes No. 2 and No. 3 with a 5:1 safety factor

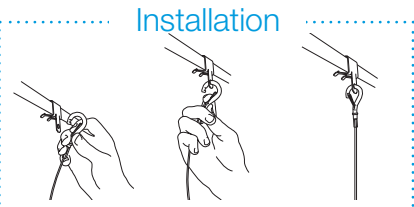

Decking Wedge (25 mm)

- Ideal for fixing into the re-entrant channel of several composite floor deckings (R51, CF51, Holorib, MD50 and MF55)
- Available in Gripple sizes No. 2 and No. 3 with a 5:1 safety factor

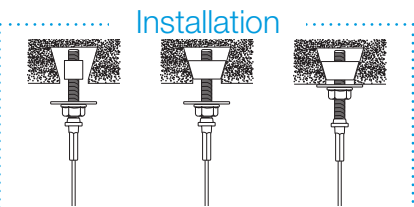

Channel Nut

- Ideal for common rail installations and multi-tier installations
- Available in Gripple sizes No. 2 and No. 3 with a 5:1 safety factor
- Fits both 41 x 41 and 41 x 21 channel
- Pre-assembled and ready-to-insert directly into channel
- No additional components required

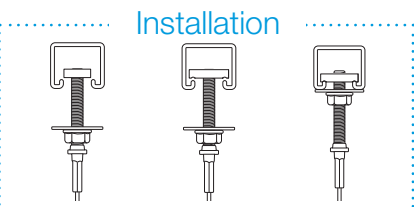

90° Eyelet

- Ideal for fixing into concrete, steel or wood using gas or powder activated tools or appropriate screws
- Available in Gripple sizes No. 1, No. 2 and No. 3 with a 5:1 safety factor

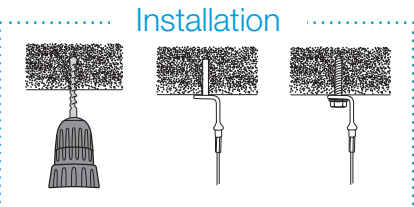



# Accessories

A variety of accessories are available to complement the product range increasing versatility and ease of installation. Individual UniGrip products are available separately as accessories to allow multi-tiered installations from one suspension wire.



**Trapeze Plus** 🔥  
The all-steel Trapeze Plus FR is supplied with steel wire rope, for the suspension of services where fire resistance is required.



**Trapeze Plus FR - Cable Basket Adaptor** 🔥  
Designed for quick attachment to channel for the fast suspension of a variety of applications including HVAC, pipework and electrical containment where fire resistance is required.



**UniGrip QT-UB**  
Quarter turn installation, designed for use with Gripple Universal Bracket suspension slot.



**Wall Bracket\***  
Designed for use in conjunction with Universal Brackets for the easy installation of wall mounted pipe and electrical services.

\*Universal Bracket sold separately



**Universal Bracket** 🔥  
A strong lightweight solution designed to be bolted to the soffit as a header rail for suspending services using the quick twist attachments. Range of lengths available on request.



**Low Profile Bracket** 🔥  
A metal framing channel for mechanical services installations, working well with QT compact clamps where pipework has to be mounted close to soffit.



**Twister**  
Keeps tail wires neat and tidy. For use with 2 mm and 3 mm wire rope.



**Torq Tensioning Tool**  
The Gripple Torq Tensioning Tool not only tensions wire but regulates the load applied too, delivering consistent results and maximising the life of your wire.

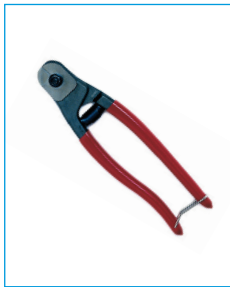

**Wire Cutters**  
Purpose-made for use on up to 4 mm wire. For use when terminating wire lengths.



**Beam and Purlin Clips**  
Available in a variety of sizes and models for attachment to beams and purlins.

# Bracket Accessories

## Conduit Clamp

Quarter turn attachment to Fast Trak brackets for quick installation of conduit.

- No specialist tools required for installation
- Available in sizes from 12.5 mm up to 100 mm
- Supports rigid and EMT conduit
- Pre-assembled with nut and bolt



## Trunking Clamp

Quarter turn attachment to Fast Trak brackets for quick installation to trunking.

- No tools or additional fixings required
- Available in 4 sizes; 50 x 50 mm, 75 x 75 mm, 100 x 100 mm and 150 x 150 mm
- Integral, hinged latch retains trunking in position
- Suitable for use with PVC and steel trunking



## QT Universal Clamp & QT Compact Clamp

Used in conjunction with Fast Trak brackets to support all types of pipework within mechanical and plumbing services.

- Integral mounting pillar and quarter turn attachment
- No tools required for installation
- Replaces more than 13 different pipe rings from 15 mm copper to 100 mm steel



## J-Hook

Used in conjunction with Fast Trak tracks to support all types of data cables.

- Gate 'lock off' can be re-opened to add additional cables
- High performance, wide base wire form design
- Fast connection onto the Fast Trak track
- 50 mm diameter; can also be used for VRF/condensate pipes



## CB Clip

For quick fastening of cable basket to Gripple Fast Trak.

- Prevents uplift and slide of basket
- Two sizes available to fit 4 mm and 5 mm cable basket wire
- Tool-free, quarter turn installation
- Time saving compared to traditional methods

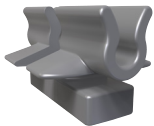

## CT Clip

For quick fastening of cable tray to Gripple Fast Trak, Universal and G Brackets.

- Prevents uplift and slide of tray
- Available in one size to fit 2 mm thick steel
- Tool-free, quarter turn installation
- Quick push fit fixing



## Fire Fastener

A fire rated push-fit fastener designed for attaching onto a Fast Trak bracket. The fastener is only required when a bracket is in a 'u' orientation (i.e. channel side up).

- Quick installation with no tools required
- Simple push fit-design
- Compatible with Fast Trak in fire rated applications
- Can be used for new and retrofit installations



## Bracket Cover

Neatly hides tracks to further enhance the aesthetics of the Fast Trak system.

- Discrete finish; ideal for open soffit spaces
- Tool free and simple 'snap fit' installation
- Can be cut down to specific lengths
- Covers metal edges that would usually protrude below the bracket

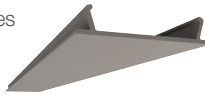

## Catenary Wall Bracket

Ideal for attaching a 6 mm or 3 mm catenary (CTI) kit from a concrete wall or wooden beam.

- 100 mm x 100 mm back plate for concrete walls and wooden beams
- 4 x 11 mm diameter mounting holes
- 65 mm hole spacing
- 9 mm ring for easy wire rope attachment
- Zinc plated finish (minimum 5 µ)









Fast Trak Bracket Data

Maximum Working Load\*

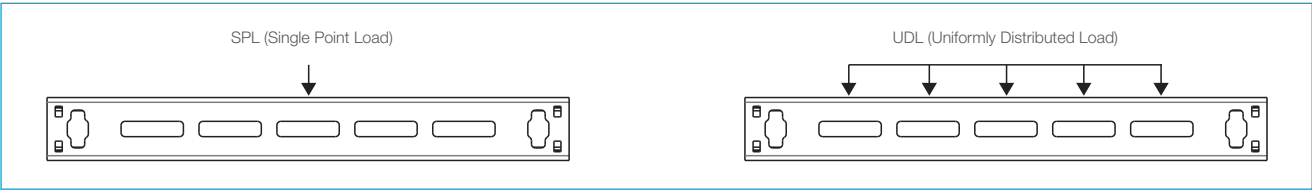

Fast Trak - Standard (kg/kN)

FTB-270 to FTB-1370

Bracket Orientation**	'n' orientation		'c' orientation	
Single Point Load (SPL) @ 3:1	100 kg	0.98 kN	70 kg	0.68 kN
Uniformly Distributed Load (UDL) @ 3:1	200 kg	1.96 kN	130 kg	1.27 kN

FTB-1470

Single Point Load (SPL) @ 3:1	100 kg	0.98 kN	70 kg	0.68 kN
Uniformly Distributed Load (UDL) @ 3:1	175 kg	1.71 kN	130 kg	1.27 kN

Fast Trak - Low Profile (kg)

Bracket	FTBL 190	FTBL 290	FTBL 390	FTBL 490	FTBL 590	FTBL 690	FTBL 990	FTBL 890	FTBL 990	FTBL 1090	FTBL 1190	FTBL 1290	FTBL 1390	FTBL 1490
UDL (Uniformly Distributed Load)	230	160	130	110	100	90	70	70	55	55	50	40	40	35
SPL (Single Point Load)	175	115	75	70	60	50	40	40	30	30	25	20	20	20

Fast Trak - Low Profile (kN)

Bracket	FTBL 190	FTBL 290	FTBL 390	FTBL 490	FTBL 590	FTBL 690	FTBL 990	FTBL 890	FTBL 990	FTBL 1090	FTBL 1190	FTBL 1290	FTBL 1390	FTBL 1490
UDL (Uniformly Distributed Load)	2.26	1.57	1.27	1.08	0.98	0.88	0.69	0.69	0.54	0.54	0.49	0.39	0.39	0.34
SPL (Single Point Load)	1.72	1.13	0.74	0.69	0.59	0.49	0.39	0.39	0.29	0.29	0.25	0.20	0.20	0.20

\*For more details on specified loads or additional deflection ratings please contact Gripple Technical Services. When loading multiple faces the total load applied must not exceed the values stated.

\*\*Can also be installed in a 'u' orientation but a Fire Fastener must be used to retain fire rating. Contact Gripple Technical Services for more information on this application.

Key Recommendations

Failure to comply with these recommendations may result in product malfunction and possible damage to property or person and will invalidate the Gripple guarantee. Gripple products are guaranteed to be free from defects in materials and workmanship in accordance with our terms and conditions. No other warranty, whether express or implied, including any warranty of merchantability or fitness for purpose shall exist in connection with the sale or use of any Gripple product.

Full technical information and installation instructions should be obtained directly from Gripple Limited, Gripple Europe, Gripple Inc., Gripple Japan, Gripple Poland, Gripple India, Gripple Germany, any regional Gripple office, or via the website (www.gripple.com). These Key Recommendations may be amended from time to time; please view the Key Recommendations page on the Gripple website (www.gripple.com) for the most up-to-date information.

Please adhere to the following usage recommendations:

**Loads**  
Always operate the product within its stated safe working load range. Suspend static loads only. Do not subject to shock loading. Do not adjust under load.

**Hanging at an angle to vertical**  
Ensure that the load calculation considers the effect of 'side load'. For example, at an angle of 60° to vertical the SWL is effectively reduced by 50%.

**Ducting:** When installing included angle teardrop hangers on round/spiral ducting or pipes, the final included angle of the assembly should not exceed 60°.

**Y-Fit:** Legs on Y-Fit not to be installed greater than 60°.

**Environment**  
Do not use in chlorinated or chemically corrosive atmospheres. Standard hangers are for use in dry and air conditioned environments only. Stainless steel hangers should be considered for high to saturated humid environments after validation by a competent person.

Not suitable for swimming pools.

**Joining**  
Never join two ends together in-line.

**Traceability**  
Always use the Gripple hanger with the specified wire rope supplied by Gripple. Gripple products should only be used with products supplied by Gripple Ltd., and the warranty will not apply if our products are used with any products supplied by third parties.

**Lifting**  
Do not use for lifting, either by crane or as part of a pulley system.

**Impact**  
If there is potential for impact on the wire rope suspension or suspended services, seek advice from Gripple Ltd. Technical Services prior to installation.

**Lubrication**  
Do not apply oil or any other lubricant to the hanger or any other part of the assembly.

**Wire Rope**  
Trim any damaged filaments with the wire cutter before use.

**Installation**  
Do not walk or stand on the Gripple product installation. Gripple products must not be used for personal suspension, fall protection or harnessing people.

**Painting**  
Do not paint the hanger prior to installation. Ensure the hanger is in its final position prior to applying any paint to the wire rope assembly. Do not move the fastener after painting.

**Storing**  
Do not store the product outdoors, or in damp or abnormal conditions.

**Repair, Modification and Re-use**  
Do not repair, modify or re-use Gripple products. If you have any queries regarding product performance, please contact technical.services@gripple.com

Quality & Approvals

Gripple UK is ISO 9001:2015 and ISO 14001 certified. Gripple products meet the highest standards of quality with lowest environmental impact.



Gripple's policy is one of continuous development and innovation. We therefore reserve the right to alter specifications, etc. without notice.



**www.gripple.com**  
info@gripple.com

**Gripple Ltd (Headquarters)**

The Old West Gun Works  
Savile Street East  
Sheffield S4 7UQ  
UK

**T** | +44 (0) 800 018 4264

**F** | +44 (0) 114 275 1155

**E** | info@gripple.com

**Gripple Europe SARL**

1, rue du Commerce  
BP 37  
67211 Obernai Cedex  
France

**T** | +33 (0)3 88 95 44 95

**F** | +33 (0)3 88 95 08 78

**E** | frinfo@gripple.com

**Gripple Inc**

1611 Emily Lane  
Aurora  
IL 60502  
USA

**T** | +1 866 474 7753

**F** | +1 800 654 0689

**E** | grippleinc@gripple.com

**Gripple India**

C-115, Industrial Area  
Phase I, Naraina  
New Delhi-110028  
India

**T** | +91-11-45136817

**F** | +91-11-45136817

**E** | ininfo@gripple.com

**Gripple Canada Inc**

6665 Tomken Road  
Units 9-10  
Mississauga, ON L5T 2C4  
Canada

**T** | +1 905 458 8700

**E** | cainfo@gripple.com

**Gripple Japan K.K**

2-57 Tsukizi-cho  
Hyogo-ku, Kobe-shi  
Hyogo, 652-0845  
Japan

**T** | +81 (0) 78 681 2121

**F** | +81 (0) 78 681 2122

**E** | japan@gripple.com



A GLIDE company



**BROC-MEP-ENG**

Published September 2021

Please refer to [www.gripple.com](http://www.gripple.com) for  
the most up to date user advice and  
product information.



© 2021 Gripple.

Gripple is a registered trademark of Gripple Limited.  
Company registered in England No. 1772901, VAT Reg No. GB 600 1951 88