

# Vit-S

## Trellising End Post Wire Tensioner

Quickly and easily manage your fruiting wires using Gripplle Vit-S end post wire tensioners with vertical adjustment. Suitable for a range of end posts.

- Ideal for single and dual line trellising installations
- Quickly adjust fruiting wire height throughout the season
- Compatible with a range of end posts
- Minimal training required



## Product Configurations

Vit-S	Individual tensioners for attachment directly onto some metal posts or use with Vit-S accessories
Vit-S Bracket Kit	Vit-S tensioner and bracket combined kit
Vit-S Bracket 30 degree	Vit-S tensioner and bracket kit off set at 30 degrees to accommodate angled end posts

## Product Specification

- Working load: 400 kg | 880 lbs
- Wire range: 1.40 mm - 2.60 mm
- Wire range (ga): 17 swg - 12 1/2 swg

## Materials

### Vit-S

- **Tensioner Housing:** Zinc- Aluminium alloy ZA2
- **Roller:** Ceramic (Sintox)
- **End cap:** UV Stabilized PP
- **Bracket:** Galvanised DX51D
- **Spring:** Stainless steel

## Compatibility

Post Compatibility	Vit-S – Stand Alone	Vit-S & Hook	Vit-S & Post Bracket
Wooden Post Dimensions	*	all	*
Concrete Post Dimensions		*	120 mm   4.7 in
Metal Post Dimensions	Some depending on design**		120 mm   4.7 in

\*Shaded grey boxes indicate that the product is not compatible.

\*\*Please reach out to [info@gripplle.com](mailto:info@gripplle.com) for more information

[gripplle.com](https://gripplle.com)

Design & Dimensions

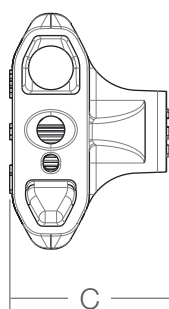
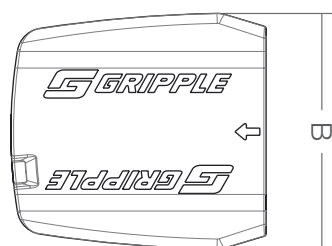
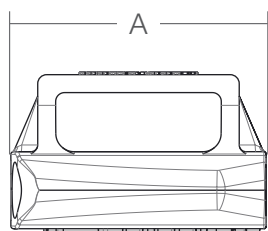

Vit-S – Wire Tensioner

A - Length	28.5 mm   1.1 in
B - Width	26 mm   1.0 in
C - Depth	17 mm   0.6 in

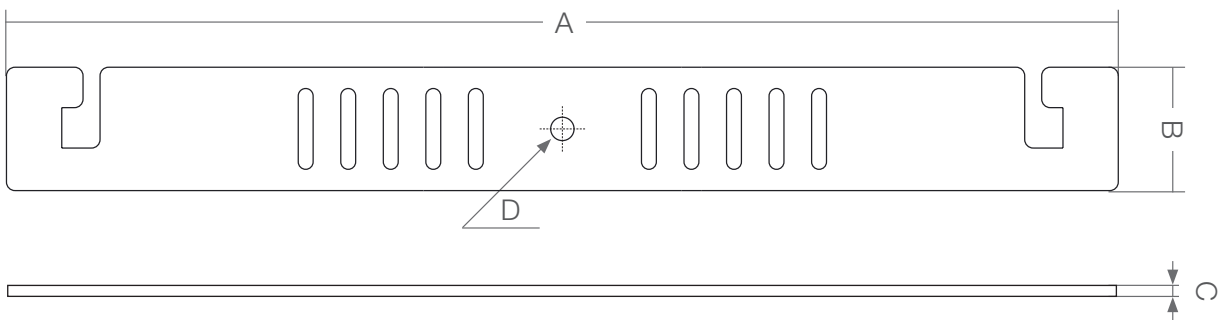

Vit-S – Bracket

A - Length	260 mm   10.2 in
B - Width	29 mm   1.1 in
C - Depth	2 mm   0.8 in
D - Screw hole	5.5 mm   0.2 in

Design & Dimensions

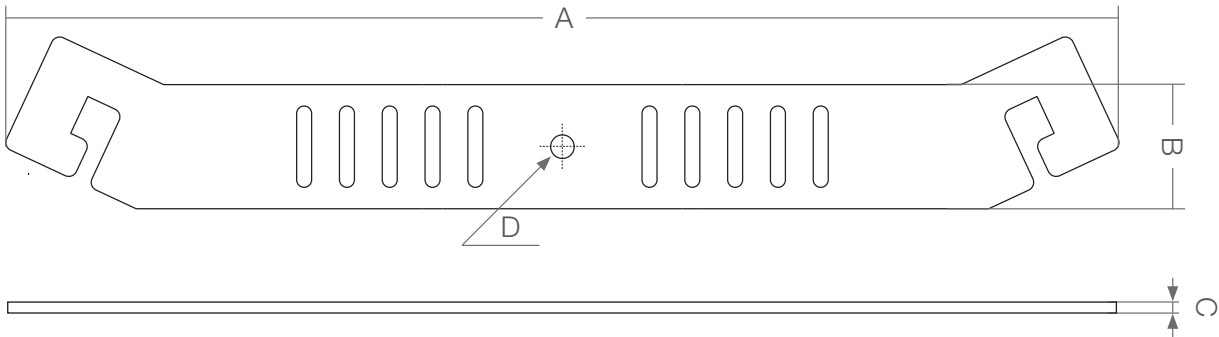

Vit-S – Bracket 30 degrees

A - Length	260 mm   10.2 in
B - Width	29 mm   1.1 in
C - Depth	2 mm   0.8 in
D - Screw hole	5.5 mm   0.2 in

Packaging

Vit-S – Wire Tensioner - Bagged and Boxed

Product weight	27 g   1 oz
Box quantity	100
Box weight	2.7 kg   6 lbs

Vit-S – Bracket

Product weight	154 g   5.4 oz
Box quantity	60
Box weight	9.2 kg   20 lbs

Vit-S – Bracket 30 degrees

Product weight	154 g   5.4 oz
Box quantity	60
Box weight	9.2 kg   20 lbs

## Vit-S Installation on Metal Post

- 

Offer Vit-S joiner to the hook on the metal post and slide the back latch over the hook to attach.
- 

Feed your wire through Vit-S and tension as required.
- 

Repeat steps 1-2 on the other side.

\*Different post material will require different methods of fixing the bracket