

# QT Compact Clamp



Used in conjunction with Grippler Brackets for quick and easy lower profile support of all types of pipework within mechanical and plumbing services.

## FEATURES / BENEFITS

- **Quick** – up to ten times faster than traditional methods due to integral mounting pillar and quarter turn attachment to Grippler Brackets
- **Simple** – no tools required for installation
- **Universal** – replaces more than 13 different pipe rings from 1/2" copper to 6" steel
- **Robust** – retractable sleeve, pre-fitted to cable to prevent galvanic corrosion
- **Versatile** – a variety of rubber pads provide insulation against vibration (noise reduction > 23 db)
- **Safe** – supplied in ready-to-use kits with Grippler Brackets for easy site storage and waste reduction

## ABOVE MOUNT BELOW MOUNT

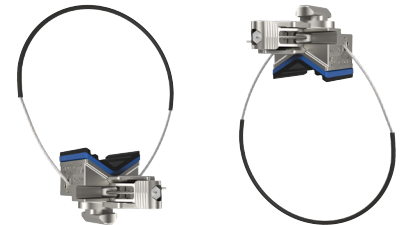

## INSTALLATION

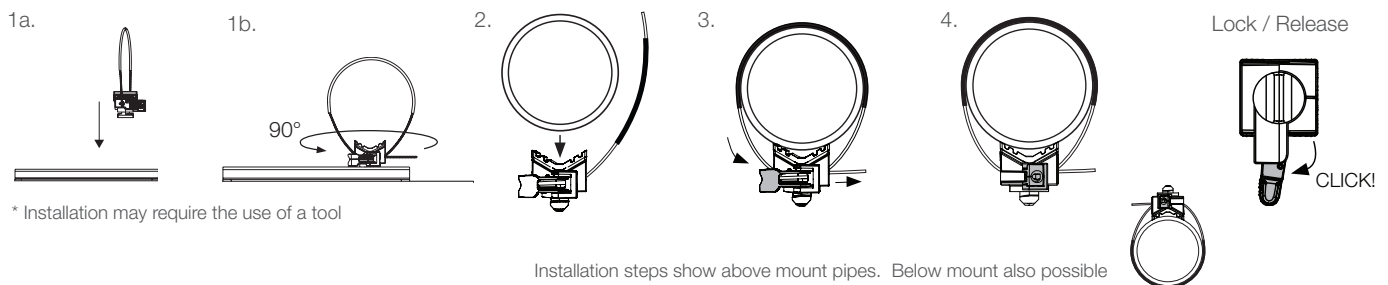

## SPECIFICATION

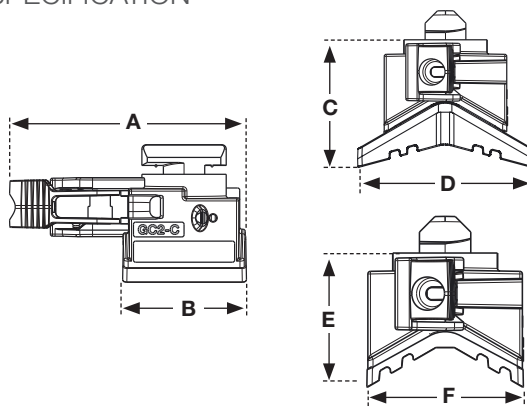

Dimension	Size	
	Inches	mm
A	2 3/16"	56 mm
B	1 1/8"	29 mm
C	7/8"	22 mm
D	1 1/8"	29 mm
E (Large Pad)	1"	25 mm
F (Large Pad)	1 1/2"	38 mm

### Cable Specification:

- 5/64" / 2 mm diameter
- 24" / 600 mm length
- Custom lengths can be made to order
- 7x7 cable construction
- 1770 N/mm<sup>2</sup> tensile strength

### Approvals:

- Load tested by Element Materials Technology (ISO 17025)
- MSS-SP-58 & IAPMO/ANSI UPC 1-2012 compliant under ICC-ES No. PMG-1320
- UL listed (UL2239-hardware for the support of conduit, tubing & cable - project file E2511132)
- Lloyds certified, TUV tested, Apave tested

## AVAILABLE BRACKETS

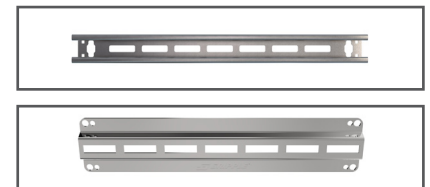

Brackets are available in multiple sizes. For more information please contact us or visit [www.grippler.com](http://www.grippler.com)

## SUBMITTAL INFORMATION

### Safe Working Load:

170 lbs / 75 kg @ 3:1 safety factor (below mount)  
1000 lbs / 450 kg @ 1.6:1 safety factor (above mount)

### Material:

Housing - Type ZA2 Zinc  
Wedge - Sintered steel hardened to min. 56 Rockwell C  
Spring - Stainless Steel (Type 302)  
End Cap - UV Stabilized homopolymer propylene  
Rubber Pad - EPDM 40±5 SHORE A  
Pin - A2 Stainless Steel