

UniGrip - Basket Tray Adaptor



A wire rope suspension product designed for the fast suspension of basket tray in single and multi-tier installations.

FEATURES / BENEFITS

- **Quick** – up to 6 times faster than traditional suspension systems
- **Versatile** – Designed for fast suspension of basket tray (up to 6 mm / 1/4" thickness). Eliminates requirement for channel bearers
- **Easy** – integral ergonomically designed release button allows for simple adjustment. Central cable exit
- **Secure** – button acts as a locking screw and indicator clearly highlights the cable is locked in position for ultimate security of central exit
- **Strong** – highest load rating capability to date; up to 120 lbs / 55 kg with 5:1 SWL

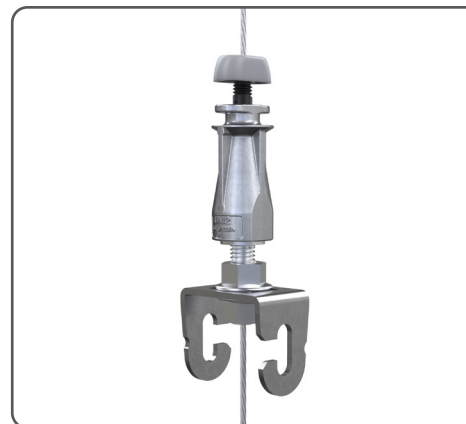

INSTALLATION & ADJUSTMENT

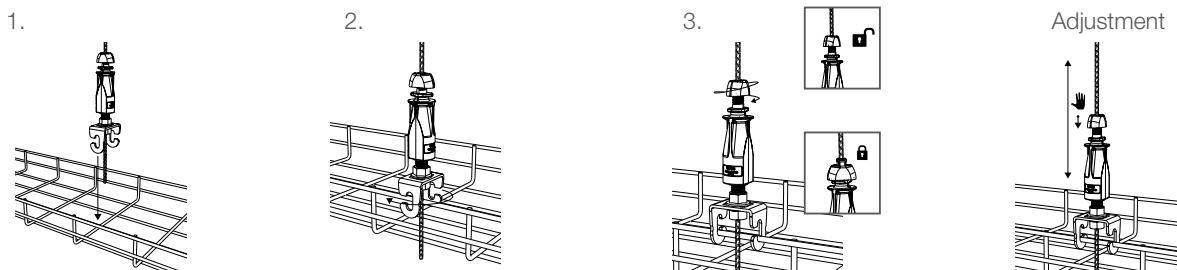

Maximum off axis suspension = 15° (Unless otherwise specified by Grippler Technical Services).

The safe working load is calculated based on the cable exiting on axis. For off-axis please contact Grippler Canada Technical Services.

SPECIFICATION

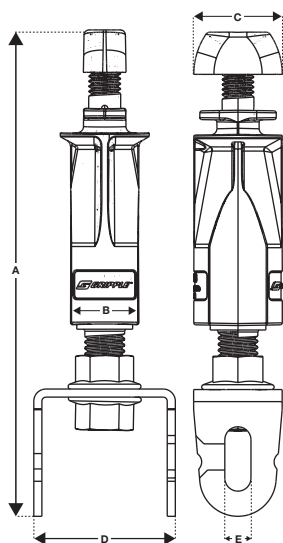

Dimension	A	B	C	D	E
No. 2					
Inches	3 3/16	11/16	13/16	1 3/8	1/4
mm	81	17	20	35	6

Foot Thread – Mild Steel (Type EN1A) - Bright Zinc Plated
Cable Basket Adapter – Steel S450GD

Maximum off axis suspension = 15° (Unless otherwise specified by Grippler Technical Services). The safe working load is calculated based on the cable exiting on axis. For off-axis please contact Grippler Canada Technical Services.

AVAILABLE END FIXINGS

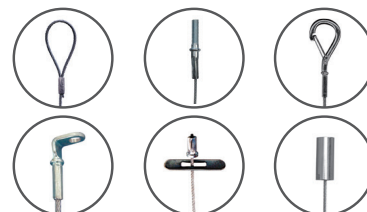

For more options on available end fixings please contact us or visit www.grippler.com

SUBMITTAL INFORMATION

Load Rating:

No. 2 - 120 lbs / 55 kg at 5:1 safety factor

Material:

Housing - Type ZA2 Zinc

Carriage - Acetal Copolymer

Wedge - Sintered steel hardened to

min. 56 Rockwell C

Button - Acetal Copolymer

Approvals: CSA & UL 1598 & UL 2239

NOT suitable for use in chlorinated / swimming pool environments.