

The next generation of cable suspension products designed for the fast suspension of electrical conduits & tray, pipework, ductwork and HVAC systems, including multi-tier installations.

## FEATURES / BENEFITS

- **Quick** – up to 6 times faster than traditional suspension systems
- **Versatile** – Designed for use with Grippler Universal Brackets. Quarter turn installation, no mechanical fix required. Central cable exit
- **Easy** – integral ergonomically designed release button allows for simple adjustment
- **Secure** – button acts as a locking screw and indicator clearly highlights the cable is locked in position for ultimate security. Safety clip for added security
- **Strong** – highest load rating capability to date; up to 240 lb / 110 kg with 5:1 SWL



## INSTALLATION & ADJUSTMENT

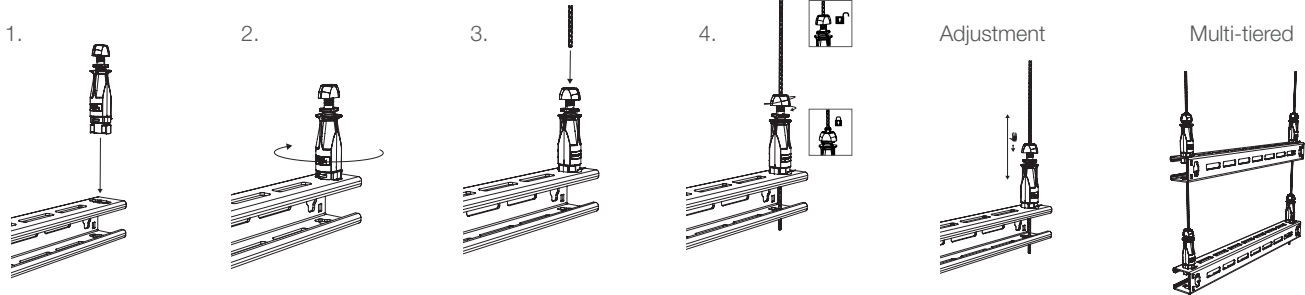

Maximum off axis suspension = 15° (Unless otherwise specified by Grippler Technical Services).

The safe working load is calculated based on the cable exiting on axis. For off-axis please contact Grippler Canada Technical Services.

## SPECIFICATION

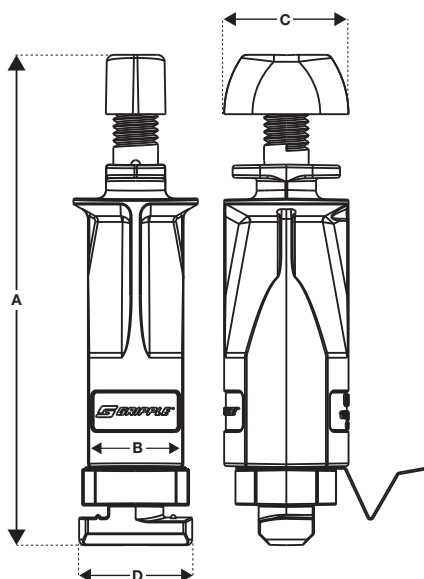

No.	Dimension	A	B	C	D
2	Inches	2 13/16	11/16	13/16	13/16
	mm	71	17	20	20

No.	Dimension	A	B	C	D
3	Inches	3 3/8	11/16	7/8	13/16
	mm	86	17	22	20

Foot	Twist Fit Adapter – Zinc Alloy (EN12844 ZP2) Spring Clip – Stainless Spring Steel BS5770 301 S21				
------	--	--	--	--	--

Maximum off axis suspension = 15° (Unless otherwise specified by Grippler Technical Services).  
The safe working load is calculated based on the cable exiting on axis. For off-axis please contact Grippler Canada Technical Services.

## AVAILABLE END FIXINGS

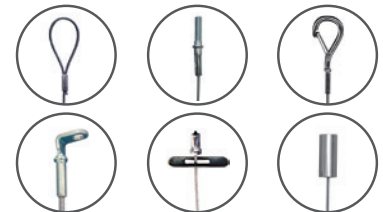

For more options on available end fixings please contact us or visit [www.grippler.com](http://www.grippler.com)

## SUBMITTAL INFORMATION

### Load Rating:

No. 2 - 120 lb / 55 kg at 5:1 safety factor  
No. 3 - 240 lb / 110 kg at 5:1 safety factor

### Material:

Housing - Type ZA2 Zinc  
Carriage - Acetal Copolymer  
Wedge - Sintered steel hardened to min. 56 Rockwell C  
Button - Acetal Copolymer

**Approvals:** CSA & UL 1598 & UL 2239  
NOT suitable for use in chlorinated / swimming pool environments.