

# Con-Vex (Wood Form)



Versatile cast-in-place concrete insert for the fast attachment of Grippler's wire rope suspension kits below the wooden deck.

## FEATURES / BENEFITS

- **Versatile** – Can support as a hanger (up to No. 3 loads) and as a bracing location (GS10-GS12)
- **Robust** – low profile design aids impact protection; insert doesn't displace when kicked or knocked on site
- **Strong** – up to 240 lb / 110 kg safe working load in low strength concrete
- **Secure** – wider footprint spreading the load to give a higher load capacity
- **Longevity** – inert material, ensures a longer design life than products which include metallic components
- **Fast** – below deck install saves time due to simple cable attachment with no assembly required



## INSTALLATION

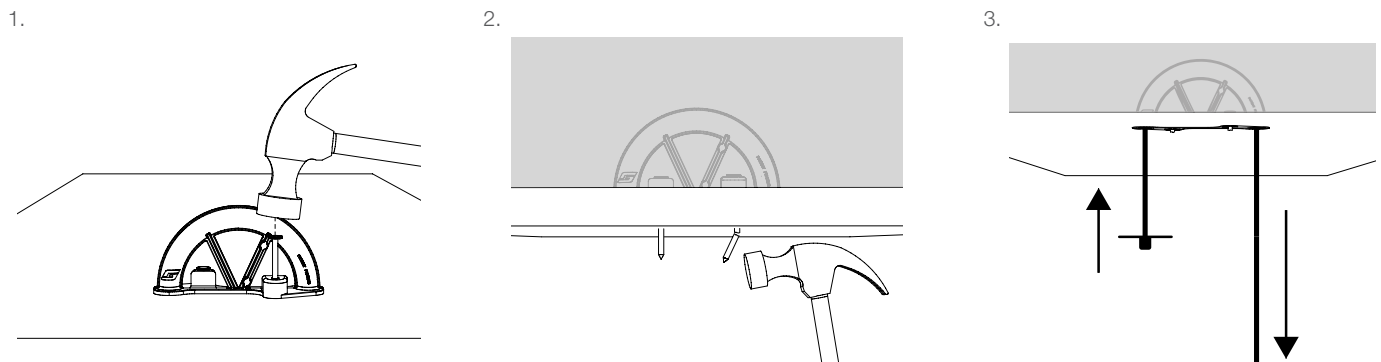

## SPECIFICATION

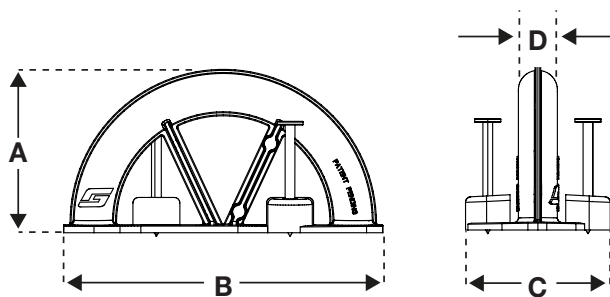

Dimension	inches	mm
A	1 3/4	44
B	3 3/8	88
C	1 1/2	39
D	7/16	10

## RECOMMENDED END FIXINGS

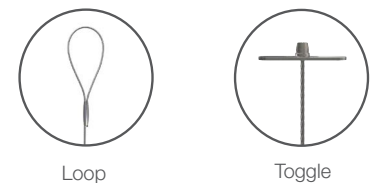

For more options on available end fixings please contact us or visit [www.grippler.com](http://www.grippler.com)

## SUBMITTAL INFORMATION

### Material:

**Body** - ABS

**Nail** - Q235 steel with Electro galvanized coating

### Load Rating:

240 lb / 110 kg with a 4:1 safety factor

SWL always depends on substrate. Load rating of anchor system may differ from that of the Grippler hanger and may govern the system SWL. Contact Grippler Canada Technical Services for more information.

BUS-PI-CVX-CAN-ENG-3956  
Published November 2020

[www.grippler.com](http://www.grippler.com)

Grippler's policy is one of continuous development and innovation. We therefore reserve the right to alter specifications, etc. without notice.



Grippler Canada | 6665 Tomken Road | Units 9-10 | Mississauga | ON | L5T 2C4

Tel +1 905-458-8700 Email [cainfo@grippler.com](mailto:cainfo@grippler.com)