

Single point suspension with two “leg” attachment points. Ideal for balanced lighting and runs of cable basket tray.

FEATURES / BENEFITS

- Single point suspension with two hanging points to enable one leg to be detached to allow access to cables, etc
- Variety of different end fixings including Snap Hook, Toggle and Mini Hook for attachment to a wide range of services
- Reduces the number of fixings required when compared to traditional trapeze hanging methods
- Supplied as a ready to use kit complete with choice of end fixing along with Gripple Express fastener (No. 1 & No. 2) or Standard Hanger fastener (No. 3)
- Industry approved

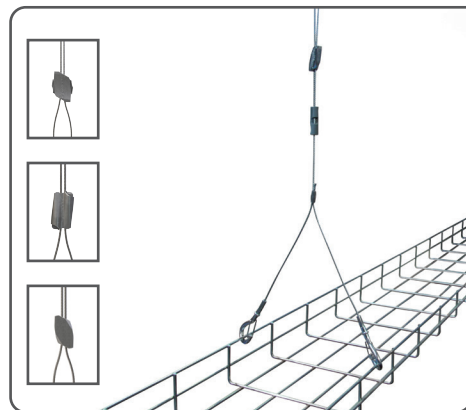

INSTALLATION

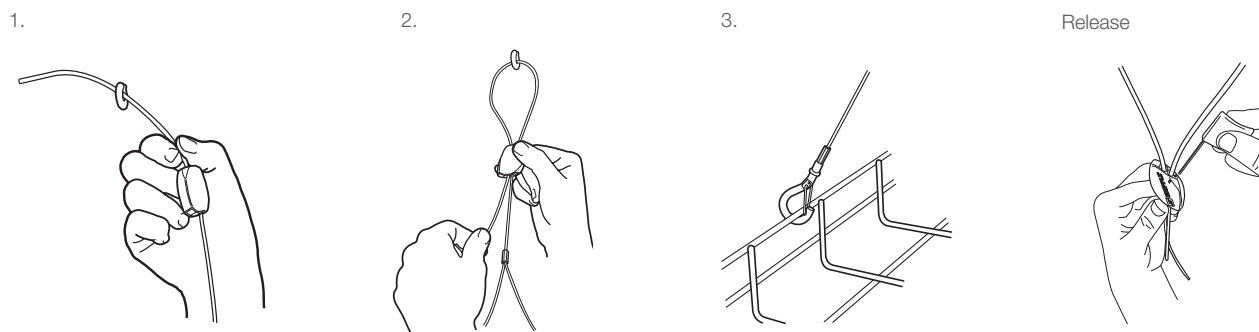

SPECIFICATION

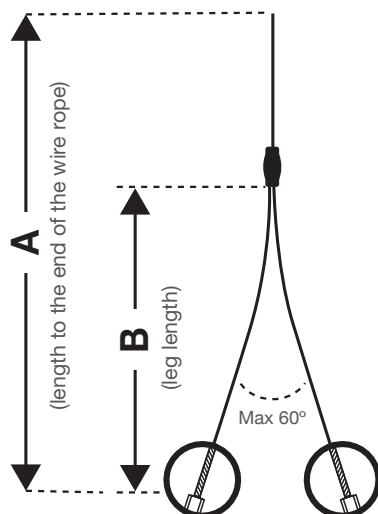

Dimensions A and B should be specified along with the required end fixing.

AVAILABLE END FIXINGS



For more options on available end fixings please contact us or visit www.gripple.com

SUBMITTAL INFORMATION

Load Rating:

- No. 1 - 33 lb / 15 kg
- No. 2 - 100 lb / 45 kg
- No. 3 - 200 lb / 90 kg
- All with 5:1 safety factor

Material:

- Cable - Galvanized Steel
- Ferrule - Aluminium