

Tool free locking device for fast suspension of a variety of services, designed with a keyless release mechanism.

FEATURES / BENEFITS

- The HF Express No.1 is ideal for signage, shopfitting, lighting and other lightweight fixtures
- The HF Express No.2 is ideal for mechanical and electrical applications
- Up to six times faster to install than traditional methods
- Keyless, no tool required for adjustment
- Ergonomic buttons allow rapid adjustment
- Discreet and aesthetic design
- Supplied as a ready-to-use kit



INSTALLATION & ADJUSTMENT

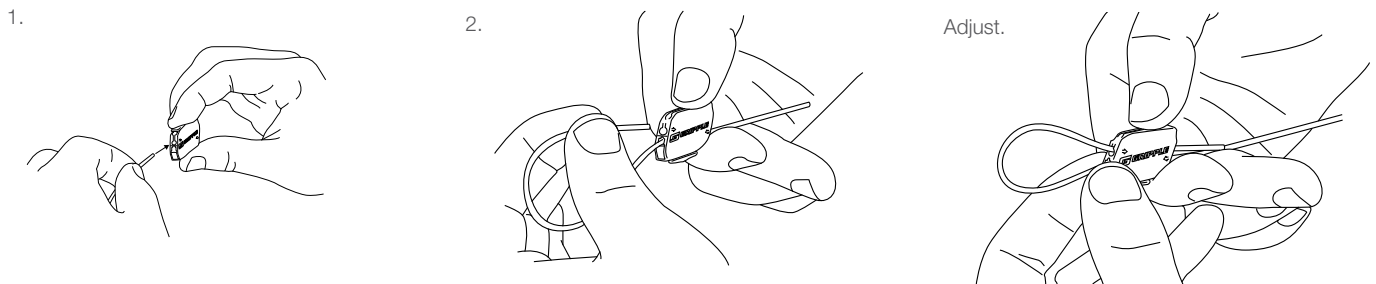

Ensure a minimum 75 mm of tail wire exit the hanger.

SPECIFICATION

HF Express No.1

HF Express No.2

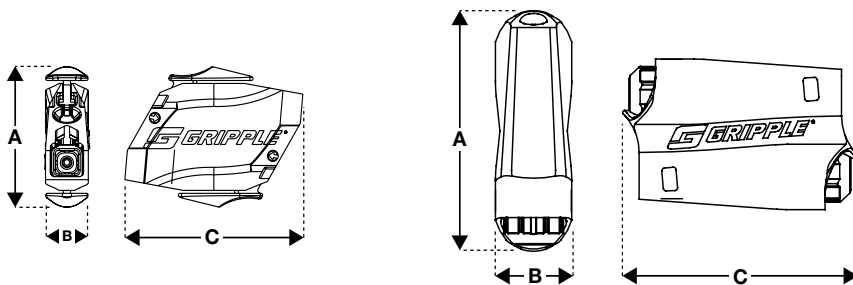

Dimension	No.1 (mm)	No.2 (mm)
A	18,5	21,4
B	5,9	11,6
C	23,5	28,4

AVAILABLE END FIXINGS



For more options on available end fixings please contact us or visit www.gripple.com

SUBMITTAL INFORMATION

Safe Working Load:

No.1 - 0 - 15 kg @ 5:1 safety factor
No.2 - 0 - 45 kg @ 5:1 safety factor

Material:

Housing - Type ZA2 Zinc
Wedge - Sintered steel hardened to min. 56 Rockwell C
Spring - Stainless Steel (Type 302)
End Cap - UV stabilised homopolymer polyene
No.1 Button - Acetal
No.2 Button - 30% Glass filled polypropylene

