

Snap hook and Mini hook



Ideal for attaching directly to existing clips, brackets, light fittings and signage.

PRODUCT INFORMATION

- Quick and easy attachment to cable basket, purlin clips, light fittings
- Available up to 90 kg SWL, with a 5:1 safety factor
- Comes as a ready-to-use kit with wire and Grippler hanger
- Available in lengths from 1 to 10 m
- Other lengths are available on request

SNAP HOOK

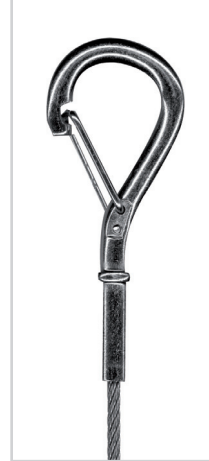

MINI HOOK



INSTALLATION

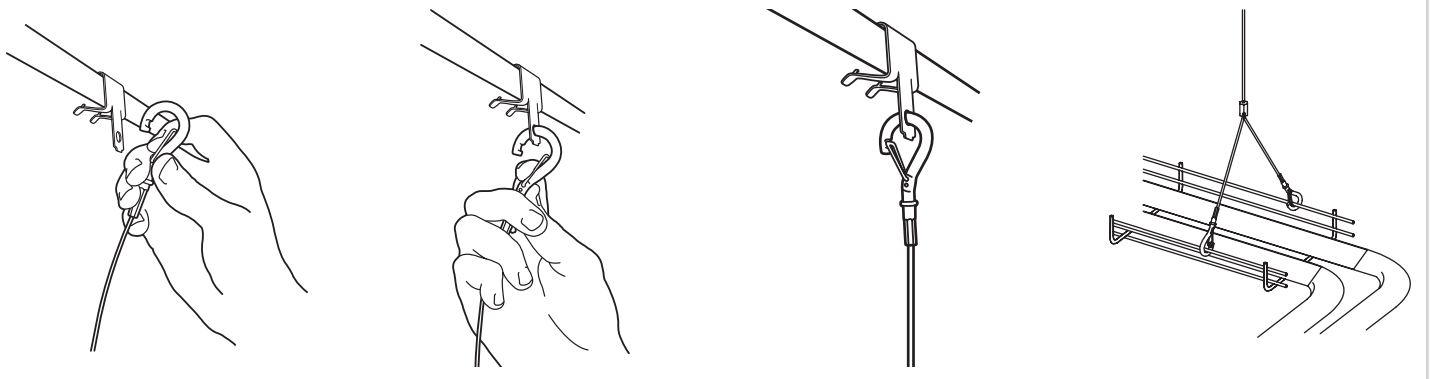

PRODUCT DIMENSIONS

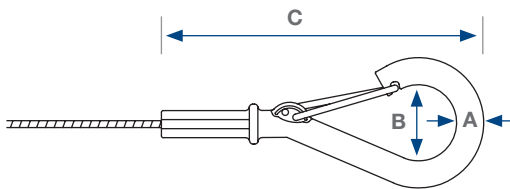

Size		A (mm)	B (mm)	C (mm)
No.1 (0 - 10 kg)	Mini	4.5	6	55
	Large	6.3	8	75
No.2 (10 - 45 kg)	Large	6.3	8	75
No.3 (45 - 90 kg)	Large	6.3	8	75

IMPORTANT INFORMATION

1. Construction materials and conditions vary on different sites. If it is suspected that the base material has insufficient strength to achieve a suitable fixing, contact Grippler Ltd. The responsibility for judgement of base material strength lies with the installer, and not with Grippler Ltd.
2. The information and recommendations given herein are believed to be correct at time of writing. The data has been obtained from tests done under laboratory, or other controlled conditions and it is the users responsibility to use the data given in light of conditions on site, taking account of the intended use of the products concerned.
3. Whilst Grippler Ltd can give general guidance and advice, the nature of Grippler products means that the ultimate responsibility for selecting the correct product for a particular application must lie with the customer.
4. All products must be used, handled and applied in accordance with current product instructions and manufacturers recommendations for use, published by Grippler Ltd.
5. Grippler's policy is one of continuous development and innovation. We therefore reserve the right to alter specifications, etc. without notice.