

## End Fixing

Magnetic Pad enables quick and easy installation of signage and services to metal surfaces

### FEATURES / BENEFITS

- Ideal for hanging signage and fixing services to ferrous metal surfaces
- Load is affected by the metal thickness and surface condition (painted finish)
- Not for use on aluminium, brass or non-metallic products
- Comes as a complete kit with wire, Gripple fastener and setting key



### INSTALLATION

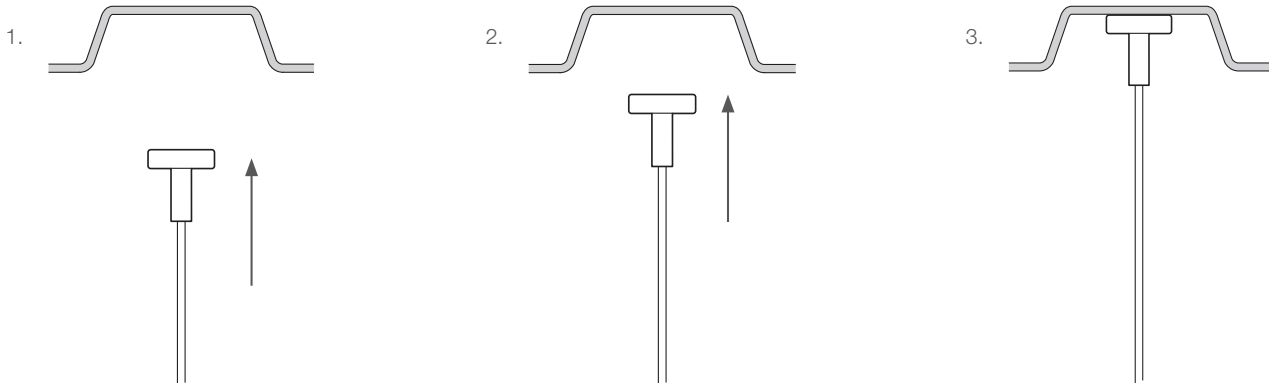

### SPECIFICATION

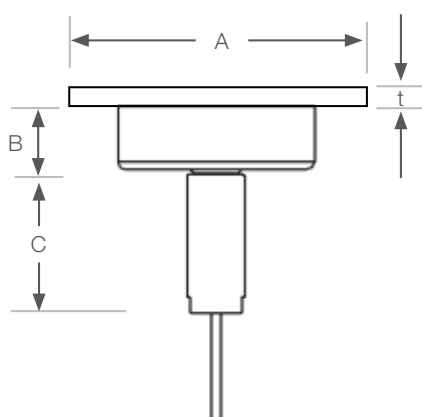

Dimension	mm
A	25
B	8
C	45

### SUBMITTAL INFORMATION

Metal Thickness (t)	SWL
1 mm	3 kg
2 mm	6 kg
>3 mm	8 kg

#### Material:

Housing - Mild Steel  
Finish - Zinc Plate

### AVAILABLE HANGERS

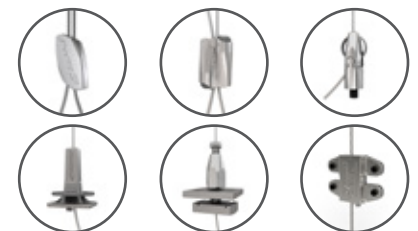

For more options on available hangers please contact us or visit [www.gripple.com](http://www.gripple.com)

### Magnet do's and dont's

1. Magnets only attract to ferrous materials eg. steel products including galvanised steel and iron based products.
2. Magnets do not attract aluminium, plastic or brass.
3. Maximum working temperature 80°C.
4. Handle with care, magnets are strong. Wear protective gloves and handle carefully to avoid trapping of skin.
5. Magnets are brittle, do not allow them to 'crash' together as pieces may break off.
6. Magnets can magnetically damage sensitive equipment when brought into close proximity eg. televisions, computer screens and discs, pacemakers, credit cards etc.
7. Magnetic pull strength figures are based on full magnetic flux being absorbed and can vary with the thickness of the material to which the magnet is attached.